

EC-11

Socket for 11-pin standard Relays

Rated Load **10 A / 400 V**

Specifications

Rated impulse withstand voltage	2.5 kV rms / 1 min
- All terminals / DIN rail	2.5 kV rms / 1 min
- Terminal / Terminal	
Cross-section of connecting wire	
- Single-wire	4 mm ² / AWG 12 or 2 x 2.5 mm ² / AWG 14
- Multi-wire	0.34 mm ² / AWG 22 - 2.5 mm ² / AWG 14
Nominal screw torque	0.7 Nm
Screw Dimensions (mm)	M3.5 Pozi slot
Mounting	TS-35 or Back Panel Mounting
Ambient temperature operation/storage	-25...60 °C / -40 ... 80 °C (no ice)
Weight	56 g



Connection diagram

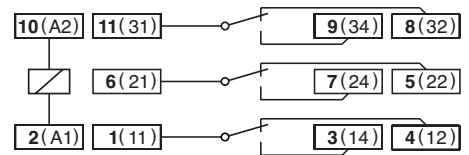

Dimensions (mm)

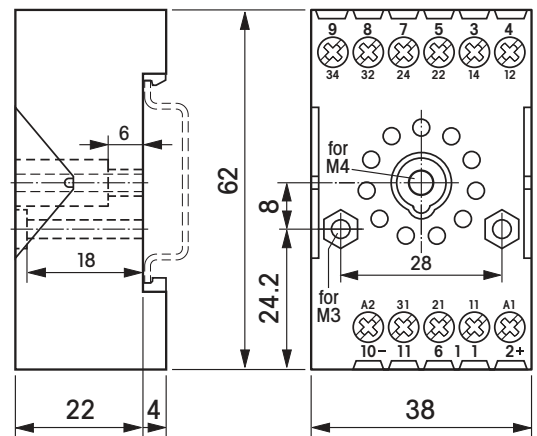

Technical approvals, conformities



S2-B

Socket for 8-pin Relays and Time Cubes

Rated Load **10 A / 300 V**

Specifications

Rated impulse withstand voltage	2.5 kV rms / 1 min
- All terminals / DIN rail	2.5 kV rms / 1 min
- Terminal / Terminal	
Cross-section of connecting wire	
- Single-wire	4 mm ² / AWG 12 or 2 x 2.5 mm ² / AWG 14
- Multi-wire	0.34 mm ² / AWG 22 - 2.5 mm ² / AWG 14
Nominal screw torque	0.7 Nm
Screw Dimensions (mm)	M3 Pozi slot
Mounting	TS-35 or Back Panel Mounting
Ambient temperature operation / storage	-40...60 °C / -40 ... 80 °C (no ice)
Weight	48g

Included Accessories

Retaining Clip, plastic S30-CM for C2 / C2x Relays

Optional Accessories

Retaining clip, steel HF-32 (BAG 10 PCS) for C2 / C2x Relays
HF-33 (BAG 10 PCS) for Time Cube CTx



Connection diagram

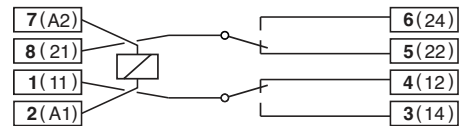

Dimensions (mm)

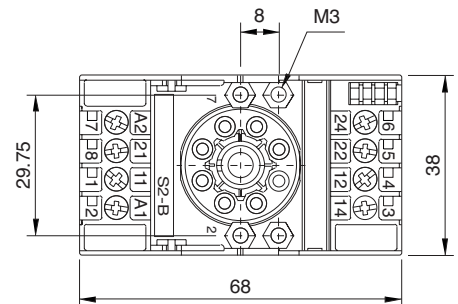
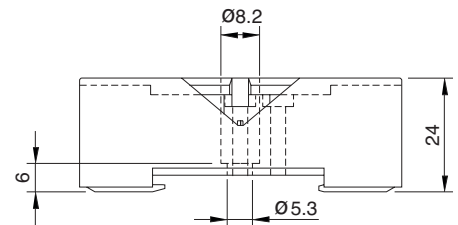

Technical approvals, conformities



S3-B

Socket for 11-pin Relays and Time Cubes

Rated Load **10 A / 300 V**

Specifications

Rated impulse withstand voltage	2.5 kV rms / 1 min
- All terminals / DIN rail	2.5 kV rms / 1 min
- Terminal / Terminal	
Cross-section of connecting wire	
- Single-wire	4 mm ² / AWG 12 or 2 x 2.5 mm ² / AWG 14
- Multi-wire	0.34 mm ² / AWG 22 - 2.5 mm ² / AWG 14
Nominal screw torque	0.7 Nm
Screw Dimensions (mm)	M3 Pozi slot
Mounting	TS-35 or Back Panel Mounting
Ambient temperature	-40 ... 60 °C / -40 ... 80 °C (no ice)
Weight	55g

Included Accessories

Retaining Clip, plastic S30-CM for C3 / C3x Relays

Optional Accessories

Retaining clip, steel HF-32 (BAG 10 PCS) for C3 / C3x Relays
 Coding Ring HF-33 (BAG 10 PCS) for Time Cube CTx
S3-BC (BAG 5 PCS) for C3 / C3x Relays



Connection diagram

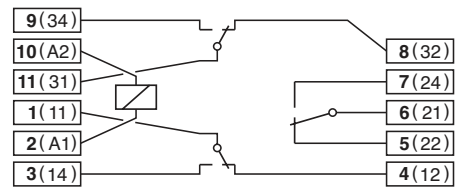

Dimensions (mm)

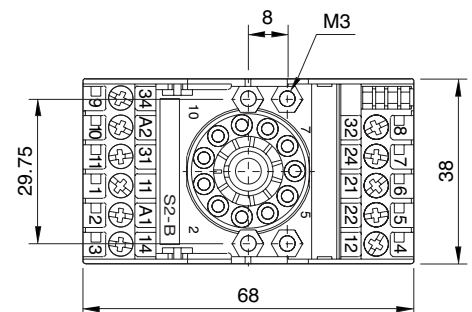
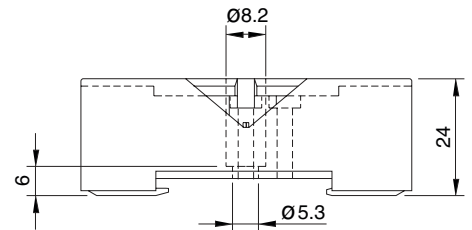

Technical approvals, conformities



S3-M

Socket for 11-pin Relays and Time / Monitoring Module



Rated Load **10 A / 250 V**

Specifications

Rated impulse withstand voltage	2.5 kV rms / 1 min
- All terminals / DIN rail	2.5 kV rms / 1 min
- Terminal / Terminal	2.5 kV rms / 1 min
Cross-section of connecting wire	
- Single-wire	1 x 6 mm ² / AWG 10, 2 x 1.5 mm ² / AWG 16
- Multi-wire	1 x 4 mm ² /AWG 12, 2 x 1.5 mm ² /AWG 16
Nominal screw torque	0.7 Nm
Screw Dimensions (mm)	M3 Pozi slot
Mounting	TS-35 or Back Panel Mounting
Ambient temperature operation/storage	-25 ... 60 °C / -40 ... 80 °C (no ice)
Weight	61g

Included Accessories

A2-Connector C-A2

Optional Accessories

Retaining clip, steel HF-32 (BAG 10 PCS) for C3 / C3x Relays
HF-33 (BAG 10 PCS) for Time Cube CTx
 Coding Ring S3-BC (BAG 5 PCS) for C3 / C3x Relays
 A2-Connector C-A2 (BAG 5 PCS), C-A2 (BAG 50 PCS)
 Free-wheeling Diode Module RD1/DC12-220V
 RC-Suppressor Module RC1/UC110-240V



Connection diagram

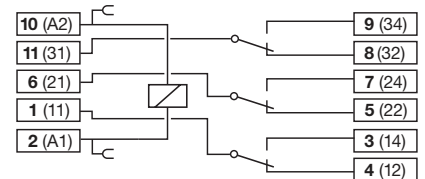

Dimensions (mm)

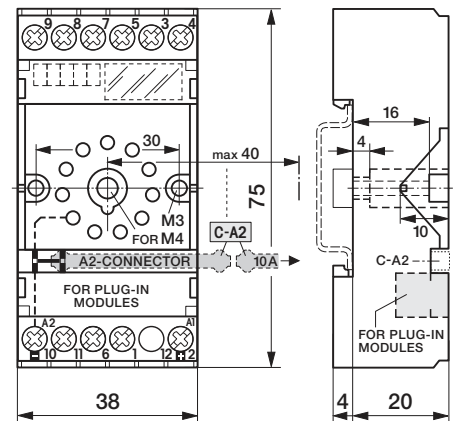

Technical approvals, conformities



IEC/EN 50155

S3-M0 / S3-M1

Socket for 11-pin Relays and Time / Monitoring Module



Rated Load **10 A / 250 V**

Specifications

Rated impulse withstand voltage	2.5 kV rms / 1 min
- All terminals / DIN rail	2.5 kV rms / 1 min
- Terminal / Terminal	
Cross-section of connecting wire	
- Single-wire	1 x 6 mm ² / AWG 10, 2 x 1.5 mm ² / AWG 16
- Multi-wire	1 x 4 mm ² /AWG 12, 2 x 1.5 mm ² /AWG 16
Nominal screw torque	0.7 Nm
Screw Dimensions (mm)	M3 Pozi slot
Mounting	TS-35 or Back Panel Mounting
Ambient temperature operation/storage	-25 ... 60 °C / -40 ... 80 °C (no ice)
Weight	61g

Included Accessories

A2-Connector C-A2

Optional Accessories

Retaining clip, steel	HF-32 (BAG 10 PCS) for C3 / C3x Relays HF-33 (BAG 10 PCS) for Time Cube CTx
Coding Ring	S3-BC (BAG 5 PCS) for C3 / C3x Relays
A2-Connector	C-A2 (BAG 5 PCS), C-A2 (BAG 50 PCS)
Free-wheeling Diode Module	RD1/DC12-220V
RC-Suppressor Module	RC1/UC110-240V

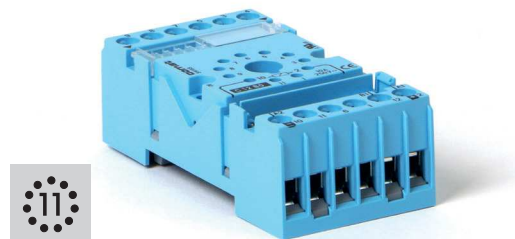

Connection diagram S3-M0

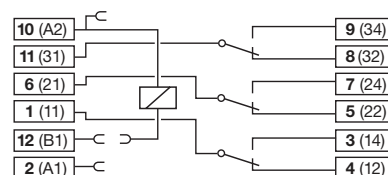

Connection diagram S3-M1

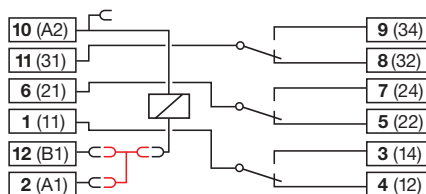

With Bridge Connector SC-3

Dimensions (mm)

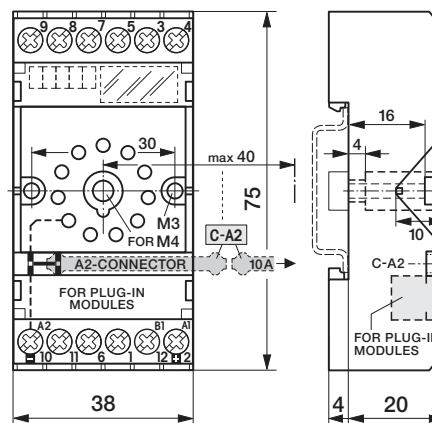

Technical approvals, conformities



IEC/EN 50155

S3-S

Socket for 11-pin standard Relays and Time Cubes

Rated Load	10 A / 250 V
Specifications	
Rated impulse withstand voltage	2.5 kV rms / 1 min
– All terminals / DIN rail	2.5 kV rms / 1 min
– Terminal / Terminal	2.5 kV rms / 1 min
Cross-section of connecting wire	
– Single-wire	4 mm ² / AWG 12 or 2 x 2.5 mm ² / AWG 14
– Multi-wire	0.34 mm ² / AWG 22 - 2.5 mm ² / AWG 14
Nominal screw torque	1.2 Nm
Screw Dimensions (mm)	M3.5 Pozi slot
Mounting	TS-35 or Back Panel Mounting
Ambient temperature operation/storage	-40...60 °C / -40 ... 80 °C (no ice)
Weight	69g

Included Accessories	
Retaining Clip, plastic	S30-CM for C3 / C3x Relays

Optional Accessories	
Retaining clip, steel	HF-32 (BAG 10 PCS) for C3 / C3x Relays HF-33 (BAG 10 PCS) for Time Cube CTx
Coding Ring	S3-BC (BAG 5 PCS) for C3 / C3x Relays

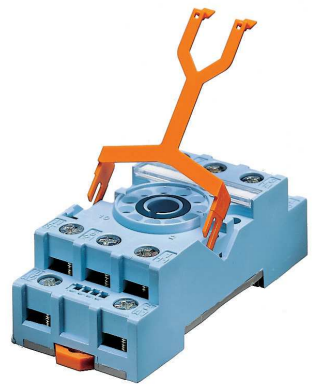

Connection diagram

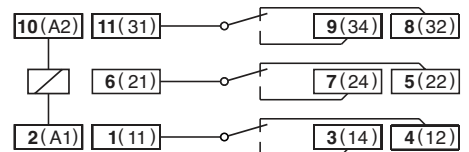

Dimensions (mm)

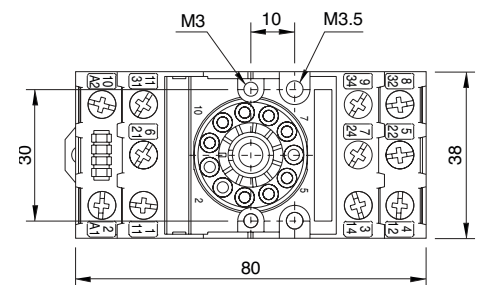
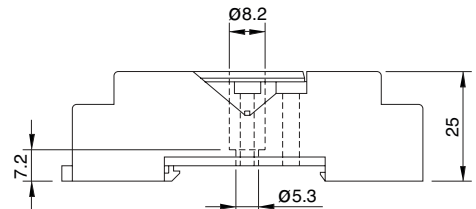

4.2 11-Pin Sockets

Technical approvals, conformities



S4-J

Socket for 14-pin C4 Relays

Rated Load	10 A / 250 V
Specifications	
Rated impulse withstand voltage	2.5 kV rms / 1 min
- All terminals / DIN rail	2.5 kV rms / 1 min
- Terminal / Terminal	
Cross-section of connecting wire	
- Single-wire	1.5 mm ² / AWG 15 or 2 x 1.5 mm ² / AWG 15
- Multi-wire	0,34 mm ² / AWG 22 - 1 mm ² / AWG 17
Nominal screw torque	1 Nm
Screw Dimensions (mm)	M3.5 Philips-slot (combo)
Mounting	TS-35 or Back Panel Mounting
Ambient temperature	-40 ... 60 °C / -40 ... 80 °C (no ice)
Weight	80g

Included Accessories	
Retaining Clip, plastic	S3-CM/CP-15B (BAG 10 PCS) for C4 Relays

Optional Accessories	
Retaining Clip, steel	S3-C (BAG 10 PCS) for C4 Relays

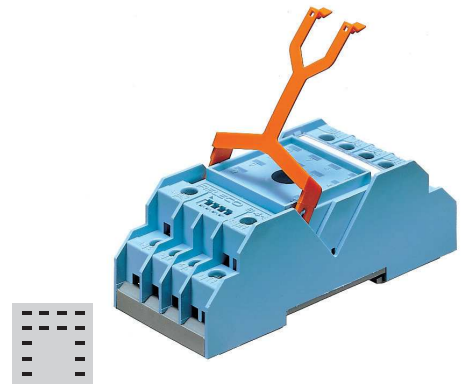

Connection diagram

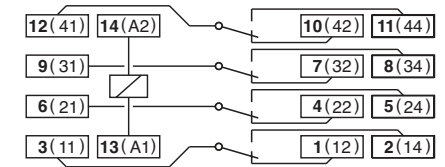

Dimensions (mm)

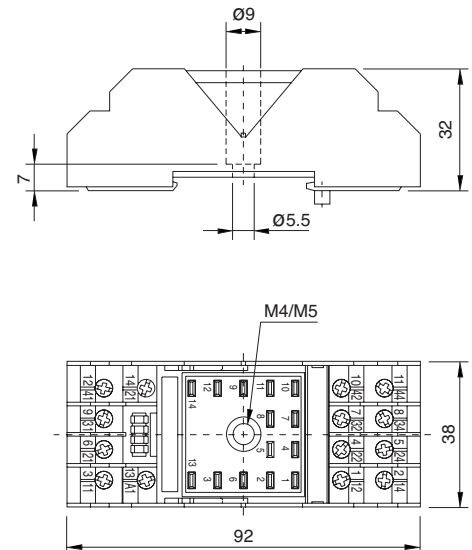

Technical approvals, conformities



S4-P

PCB Socket for 14-pin C4 Relays

Rated Load	10 A / 250 V
-------------------	---------------------

Specifications

Rated impulse withstand voltage	2.5 kV rms / 1 min
- Pin / Pin	
Ambient temperature	-30 °C ... +60 °C (no ice)
Weight	21g

Optional Accessories

Retaining spring, steel	S4-CL (BAG 10 PCS) for C4 / C4x Relays
-------------------------	--



Printed circuit lay-out (mm)

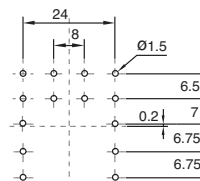

Dimensions (mm)

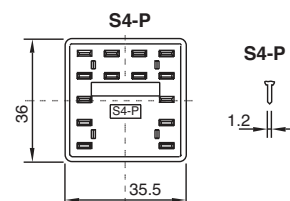

Technical approvals, conformities



S7-C

Socket for 8-pin Relays

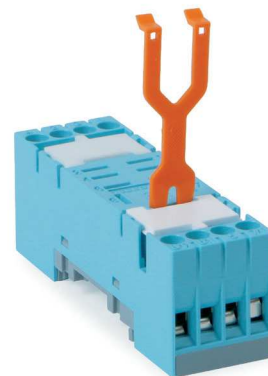

Rated Load **10A, 16A for 1 pole / 250 V**

Specifications

Rated impulse withstand voltage	
– All terminals / DIN rail	2.5 kV rms / 1 min
– Terminal / Terminal	2.5 kV rms / 1 min
Cross-section of connecting wire	
– Single-wire	4 mm ² / AWG 12, 2 x 1.5 mm ² / AWG 16
– Multi wire	2.5 mm ² / AWG 14, 2 x 1 mm ² / AWG 18
Nominal screw torque	0.7 Nm
Screw Dimensions (mm)	M3 Pozi slot
Mounting	TS-35 or Back Panel Mounting
Ambient temperature operation/storage	-40...60°C (50°C for 16A)/-40...80°C (no ice)
Weight	37g

Included Accessories

Retaining clip, plastic CP-07B for C7 / C7x Relays

Optional Accessories

Retaining clip, plastic CP-07B (BAG 50 PCS) for C7 / C7x Relays
 A2-Connector S7-BB (BAG 20 PCS)
 Panel Adapter S9-G (BAG 10 PCS)

Please Note:

This socket replaces former socket S7-M and S7-16



Connection diagram

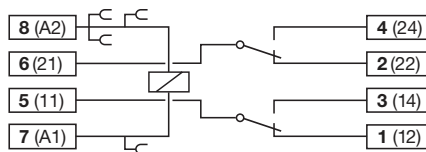

Dimensions (mm)

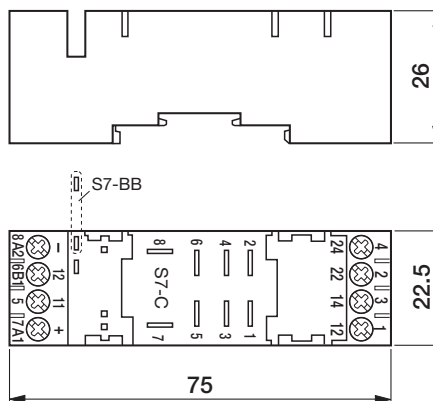

Technical approvals, conformities



S7-IO

Socket for 8-pin Relays

Rated Load	10 A / 250 V
Specifications	
Rated impulse withstand voltage	2.5 kV rms / 1 min
- All terminals / DIN rail	2.5 kV rms / 1 min
- Terminal / Terminal	2.5 kV rms / 1 min
Cross-section of connecting wire	
- Single-wire	4 mm ² / AWG 12, 2 x 2.5 mm ² / AWG 14
- Multi wire	0.34 mm ² / AWG 22 - 2.5 mm ² / AWG 14
Nominal screw torque	0.7 Nm
Screw Dimensions (mm)	M3 Pozi slot
Mounting	TS-35 or Back Panel Mounting
Ambient temperature operation/storage	-40...60 °C / -40 ... 80 °C (no ice)
Weight	38g

Included Accessories	
Retaining clip, plastic	S9-C for C7 / C7x Relays

Optional Accessories	
Retaining clip, plastic	S9-C (BAG 10 PCS) for C7 / C7x Relays
A2-Connector	S7-BB (BAG 20 PCS)
Panel Adapter	S9-G (BAG 10 PCS)

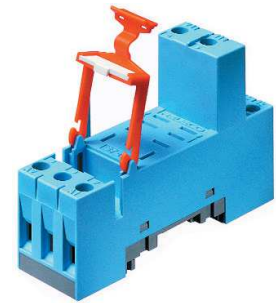

Connection diagram

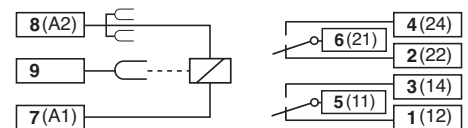

Dimensions (mm)

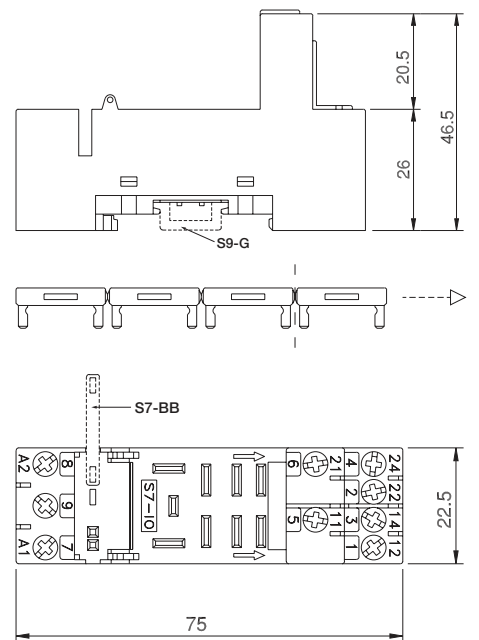

Technical approvals, conformities



S7-P

PCB Socket for 8-pin Relays

Rated Load 10 A / 250 V

Specifications

Rated impulse withstand voltage
 – Pin / Pin 2.5 kV rms / 1 min
 Ambient temperature operation/storage -40 ... 60 °C / -40 ... 80 °C (no ice)
 Weight 10g

Included Accessories

Retaining clip, plastic CP-07B for C7 / C7x Relays

Optional Accessories

Retaining clip, plastic CP-07B (BAG 50 PCS) for C7 / C7x Relays

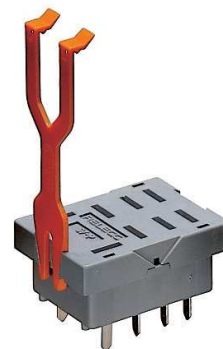

Printed circuit lay-out (mm)

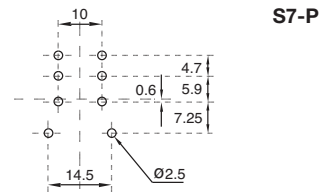

Dimensions (mm)

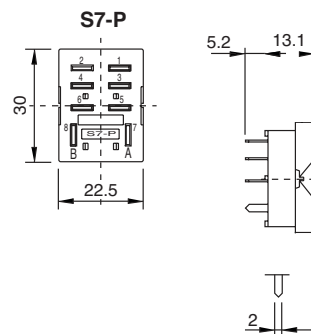

Technical approvals, conformities



S9-M

Socket for 14-pin Relays

Rated Load **6 A / 250 V**

Specifications

Rated impulse withstand voltage	2.5 kV rms / 1 min
- All terminals / DIN rail	2.5 kV rms / 1 min
- Terminal / Terminal	2.5 kV rms / 1 min
Cross-section of connecting wire	
- Single-wire	4 mm ² / AWG 12 or 2 x 2.5 mm ² / AWG 14
- Multi-wire	0.34mm ² / 22 - 2.5 mm ² / AWG 14
Nominal screw torque	0.7 Nm
Screw Dimensions (mm)	M3 Pozi slot
Mounting	TS-35 or Back Panel Mounting
Ambient temperature operation/storage	-40 ... 60 °C / -40 ... 80 °C (no ice)
Weight	54g

Included Accessories

Retaining clip, plastic S9-C for C9 / C9x Relays

Optional Accessories

Retaining clip, plastic S9-C (BAG 10 PCS) for C9 / C9x Relays
 Panel Adapter S9-G (BAG 10 PCS)
 Bridge Bar S9M-V1 (BAG 5 PCS)
 Bridge Bar S9M-V4 (BAG 5 PCS)
 Bridge Bar S9M-BX (BAG 5 PCS)

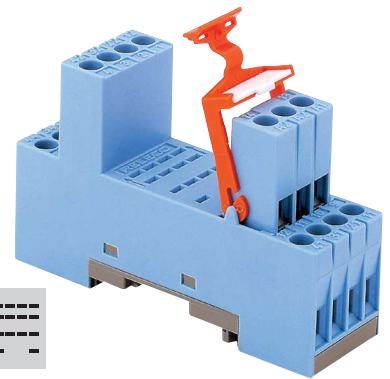

Connection diagram

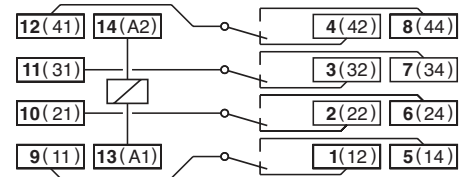

Dimensions (mm)

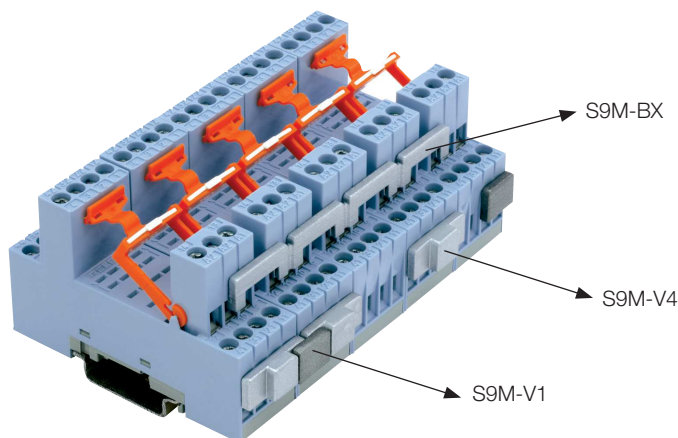
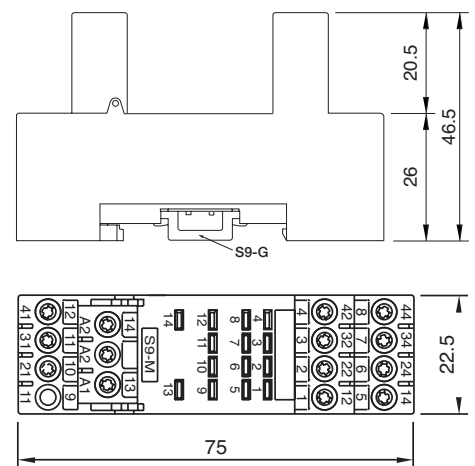

Technical approvals, conformities



S9-P

PCB Socket for 14-pin Relays

Rated Load **6 A / 150 V**

Specifications

Rated impulse withstand voltage
 – Pin / Pin 1.5 kV rms / 1 min
 Ambient temperature operation/storage -40 ... 60 °C / -40 ... 80 °C (no ice)
 Weight 12 g

Included Accessories

Retaining clip, plastic CP-07B for C9 / C9x Relays

Optional Accessories

Retaining clip, plastic CP-07B (BAG 50 PCS) for C9 / C9x Relays



Printed circuit lay-out (mm)

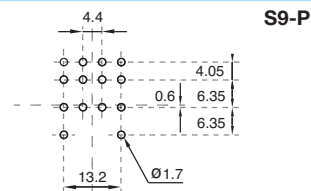

Dimensions (mm)

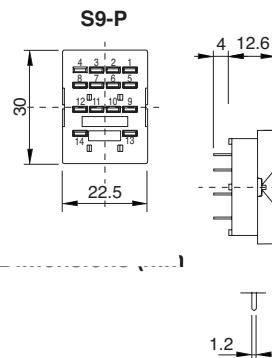

This print socket must be used in pollution degree 2 environment only, hence office, laboratory, household or similar. It is not suitable for industry environment (pollution degree 3).

Maximum voltage between two separate circuits on neighbouring contacts: 150 V
Not permitted: 24 V DC next to 230 V AC, 230 V AC next to neutral, 230 V AC next to 230 V AC of different phases
Permitted: 230 V AC next to 230 V AC same phase

Technical approvals, conformities



S10

Socket for 5-pin Relays

Rated Load	10 A / 250 V
Specifications	
Rated impulse withstand voltage	5 kV rms / 1 min
- All terminals / DIN rail	2.5 kV rms / 1 min
- Contact / Terminals	5 kV rms / 1 min
- Contact / Coil terminals	5 kV rms / 1 min
Cross-section of connecting wire	
- Single-wire	4 mm ² / AWG 12 or 2 x 2.5 mm ² / AWG 14
- Multi-wire	0.34mm ² / 22 - 2.5 mm ² / AWG 14
Nominal screw torque	0.7 Nm
Screw Dimensions (mm)	M3 Pozi slot
Mounting	TS-35 or Back Panel Mounting
Ambient temperature operation/storage	-40...60 °C / -40 ... 80 °C (no ice)
Weight	23g

Included Accessories	
Retaining Clip, plastic	S10-C for C10 / C10x Relays

Optional Accessories	
Retaining clip, plastic	S10-C / CP-17B (BAG 10 PCS) for C10 / C10x
Bridge bar	S10-BB (BAG 20 PCS)

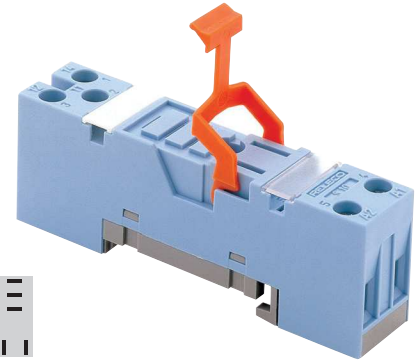

Connection diagram

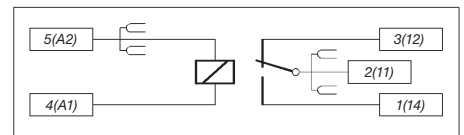

Dimensions (mm)

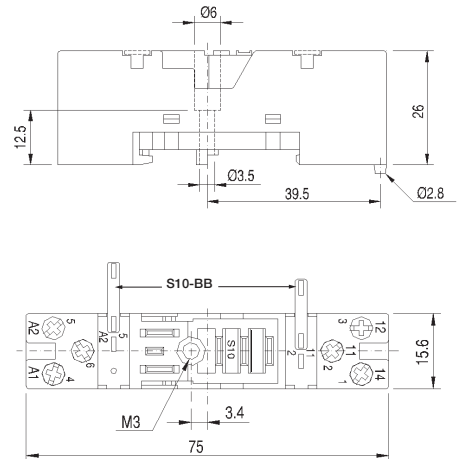

Technical approvals, conformities



S10-P

PCB Socket for 5-pin Relays

Rated Load	10 A / 250 V
Specifications	
Rated impulse withstand voltage	5 kV rms / 1 min
- Pin / Pin	-40 ... 60 °C / -40 ... 80 °C (no ice)
Ambient temperature operation/storage	
Weight	7g
Included Accessories	
Retaining clip, plastic	



Printed circuit lay-out (mm)

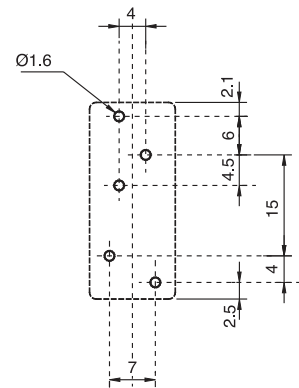

Dimensions (mm)

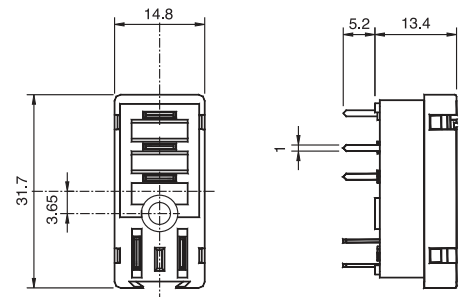

Technical approvals, conformities



S12

Socket for 8-pin Relays

Rated Load **5 A / 250 V**

Specifications

Rated impulse withstand voltage	5 kV rms / 1 min
- All terminals / DIN rail	2.5 kV rms / 1 min
- Contact / Terminals	5 kV rms / 1 min
- Contacts / Coil terminals	5 kV rms / 1 min
Cross-section of connecting wire	
- Single-wire	4 mm ² / AWG 12 or 2 x 2.5 mm ² / AWG 14
- Multi-wire	0.34mm ² / 22 - 2.5 mm ² / AWG 14
Nominal screw torque	0.7 Nm
Screw Dimensions (mm)	M3 Pozi slot
Mounting	TS-35 or Back Panel Mounting
Ambient temperature operation/storage	-40 ... 60 °C / -40 ... 80 °C (no ice)
Weight	31g

Included Accessories

Retaining Clip, plastic S10-C for C12 / C12x Relays

Optional Accessories

Retaining Clip, plastic S10-C / CP-17B (BAG 10 PCS)
for C12 / C12x Relays

A2-Connector grey B20-G (BAG 5 PCS)
 A2-Connector red B20-R (BAG 5 PCS)
 A2-Connector blue B20-A (BAG 5 PCS)
 Bridge Bar twofold grey V10-G (BAG 5 PCS)
 Bridge Bar twofold red V10-RC (BAG 5 PCS)
 Bridge Bar twofold blue V10-AC (BAG 5 PCS)
 Bridge Bar fourfold grey V40-G (BAG 5 PCS)
 Bridge Bar fourfold red V40-R (BAG 5 PCS)
 Bridge Bar fourfold blue V40-AC (BAG 5 PCS)

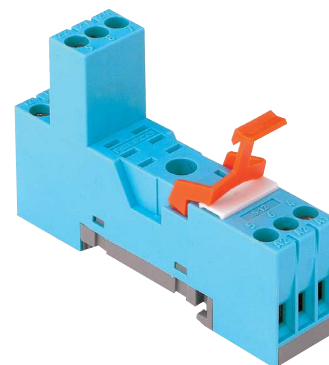

Connection diagram

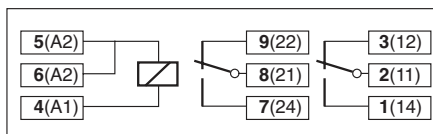

Dimensions (mm)

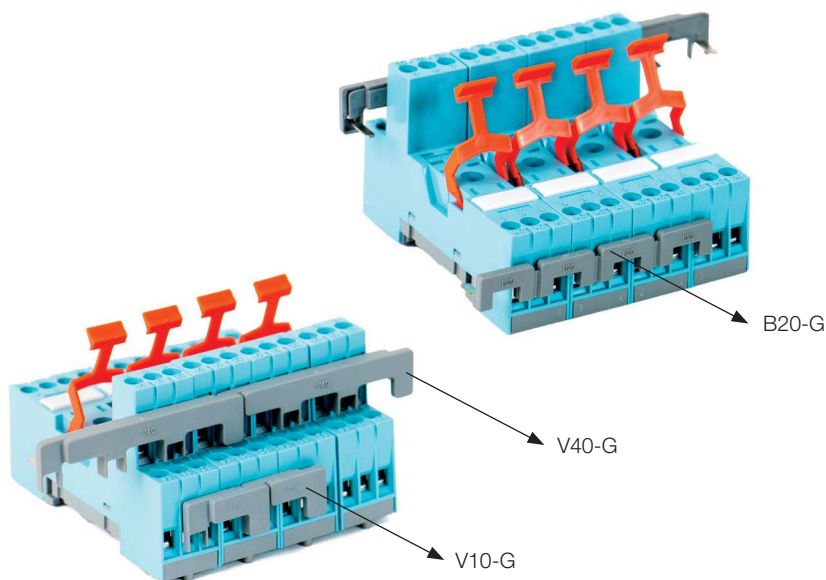
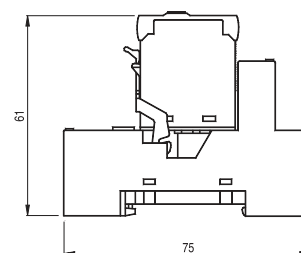
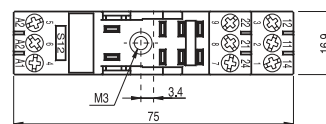
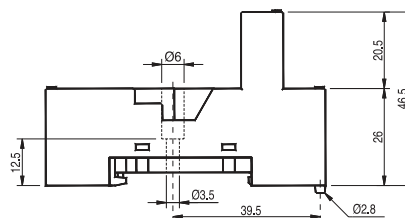

Technical approvals, conformities



S12-P

PCB Socket for 8-pin Relays

Rated Load **5 A / 250 V**

Specifications

Rated impulse withstand voltage	
- Pin / Pole	3 kV rms / 1 min
- Coil / contact terminals	5 kV rms / 1 min
Weight	7g

Included Accessories

Retaining clip, plastic CP-24B (BAG 10 PCS) for C12 / C12x Relays



Printed circuit lay-out (mm)

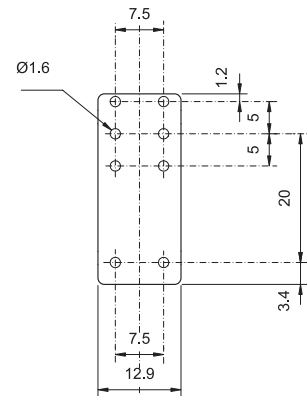

Dimensions (mm)

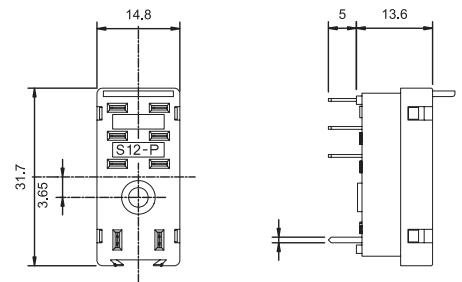

Technical approvals, conformities



S7-PI

8-pin C7 Relay socket | Push-In



General data

Rated load	10 A, 16 A for 1 pole / 250 V
Dielectric strength	
– All terminals / DIN rail	4 kV rms / 1 min
– Terminal / terminal	4 kV rms / 1 min
– Contact / coil terminal	4 kV rms / 1 min
Cross-section of connecting wire	
– Single-wire	2 x 0.34 mm ² / AWG 22 ... 2 x 2.5 mm ² / AWG 14
– Multi wire (un-crimped)	2 x 0.34 mm ² / AWG 22 ... 2 x 2.5 mm ² / AWG 14
– Multi wire (crimped)	2 x 0.34 mm ² / AWG 22 ... 2 x 1.5 mm ² / AWG 16
Mounting	TH35 (EN 60715)
Ambient temperature storage (no ice)	-40 ... 80 °C
Ambient temperature operation	-40 ... 60 °C (50 °C for 16 A)
Weight	46 g
Housing material	PA

Included accessories

Retaining clip, plastic	S7-CPI for C7 / C7x Relays
-------------------------	----------------------------

Optional accessories

Retaining clip, plastic	S7-CPI (BAG 10 PCS) for C7 / C7x Relays
Bridge bar	Sxx-BBPI (BAG 20 PCS)
Push-in tool	TM-1
Marking	Label strip BS11-PI (Wago Smart Printer compatible)

Applicable tools

Operation tool	ISO 2380-1 Shape A, width: 2.5 mm
----------------	-----------------------------------



fig. 1. Wiring diagram

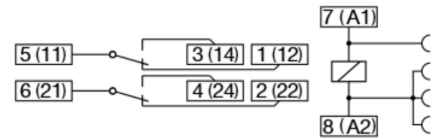
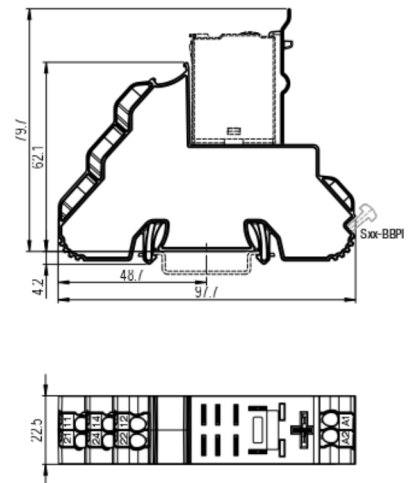

fig. 2. Dimension (mm)



Technical approvals, conformities

Standards EN 60664-1

Approvals

S7-PIR

8-pin R7 Relay socket | Push-In



General data	
Rated load	10 A, 16 A for 1 pole / 250 V
Dielectric strength	
- All terminals / DIN rail	4 kV rms / 1 min
- Terminal / terminal	4 kV rms / 1 min
- Contact / coil terminal	4 kV rms / 1 min
Cross-section of connecting wire	
- Single-wire	2 x 0.34 mm ² / AWG 22 ... 2 x 2.5 mm ² / AWG 14
- Multi wire (un-crimped)	2 x 0.34 mm ² / AWG 22 ... 2 x 2.5 mm ² / AWG 14
- Multi wire (crimped)	2 x 0.34 mm ² / AWG 22 ... 2 x 1.5 mm ² / AWG 16
Mounting	TH35 (EN 60715)
Ambient temperature storage (no ice)	-40 ... 80 °C
Ambient temperature operation	-40 ... 70 °C (50 °C for 16 A)
Weight	46 g
Housing material	PA
Included accessories	
Retaining clip, plastic	S7-CPI for R7 / R7x Relays
Optional accessories	
Retaining clip, plastic	S7-CPI (BAG 10 PCS) for R7 / R7x Relays
Bridge bar	Sxx-BBPI (BAG 20 PCS)
Push-in tool	TM-1
Marking	Label strip BS11-PI (Wago Smart Printer compatible)
Applicable tools	
Operation tool	ISO 2380-1 Shape A, width: 2.5 mm



fig. 1. Wiring diagram

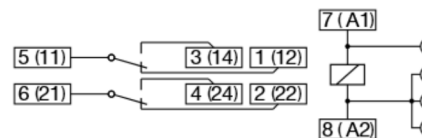
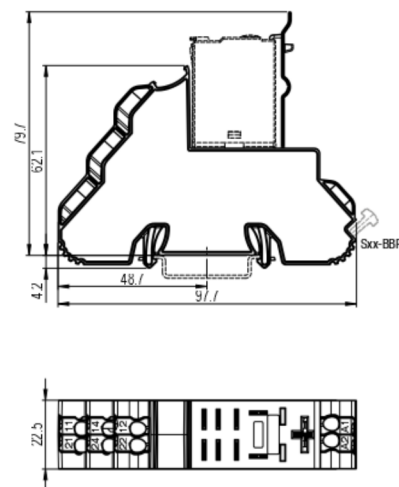

fig. 2. Dimension (mm)



Technical approvals, conformities

Standards EN 60664-1;
 Railway standards EN 50155; EN 45545-2
 Approvals

S9-PI

14-pin C9 Relay socket | Push-In



General data

Rated load	6 A / 250 V
Dielectric strength	
– All terminals / DIN rail	4 kV rms / 1 min
– Terminal / terminal	4 kV rms / 1 min
– Contact / coil terminal	4 kV rms / 1 min
Cross-section of connecting wire	
– Single-wire	2 x 0.34 mm ² / AWG 22 ... 2 x 2.5 mm ² / AWG 14
– Multi wire (un-crimped)	2 x 0.34 mm ² / AWG 22 ... 2 x 2.5 mm ² / AWG 14
– Multi wire (crimped)	2 x 0.34 mm ² / AWG 22 ... 2 x 1.5 mm ² / AWG 16
Mounting	TH35 (EN 60715)
Ambient temperature storage (no ice)	-40 ... 80 °C
Ambient temperature operation	-40 ... 60 °C
Weight	62 g
Housing material	PA

Included accessories

Retaining clip, plastic	S7-CPI for C9 / C9x Relays
-------------------------	----------------------------

Optional accessories

Retaining clip, plastic	S7-CPI (BAG 10 PCS) for C9 / C9x Relays
Bridge bar	Sxx-BBPI (BAG 20 PCS)
Push-in tool	TM-1
Marking	Label strip BS11-PI (Wago Smart Printer compatible)

Applicable tools

Operation tool	ISO 2380-1 Shape A, width: 2.5 mm
----------------	-----------------------------------

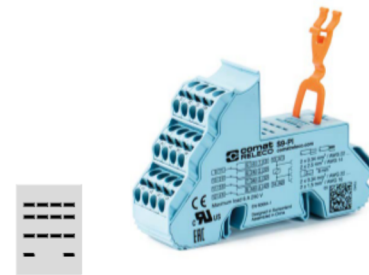

fig. 1. Wiring diagram

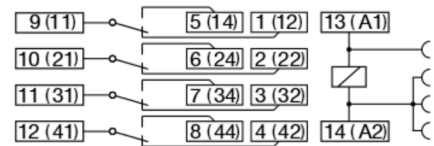
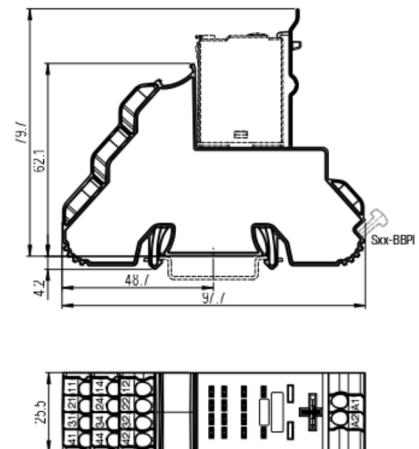

fig. 2. Dimension (mm)



Technical approvals, conformities

Standards EN 60664-1

Approvals

S9-PIR

14-pin R9 Relay socket | Push-In



General data	
Rated load	6 A / 250 V
Dielectric strength	
- All terminals / DIN rail	4 kV rms / 1 min
- Terminal / terminal	4 kV rms / 1 min
- Contact / coil terminal	4 kV rms / 1 min
Cross-section of connecting wire	
- Single-wire	2 x 0.34 mm ² / AWG 22 ... 2 x 2.5 mm ² / AWG 14
- Multi wire (un-crimped)	2 x 0.34 mm ² / AWG 22 ... 2 x 2.5 mm ² / AWG 14
- Multi wire (crimped)	2 x 0.34 mm ² / AWG 22 ... 2 x 1.5 mm ² / AWG 16
Mounting	TH35 (EN 60715)
Ambient temperature storage (no ice)	-40 ... 80 °C
Ambient temperature operation	-40 ... 70 °C
Weight	62 g
Housing material	PA

Included accessories	
Retaining clip, plastic	S7-CPI for R9 / R9x Relays

Optional accessories	
Retaining clip, plastic	S7-CPI (BAG 10 PCS) for R9 / R9x Relays
Bridge bar	Sxx-BBPI (BAG 20 PCS)
Push-in tool	TM-1
Marking	Label strip BS11-PI (Wago Smart Printer compatible)

Applicable tools	
Operation tool	ISO 2380-1 Shape A, width: 2.5 mm



fig. 1. Wiring diagram

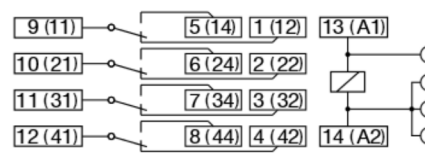
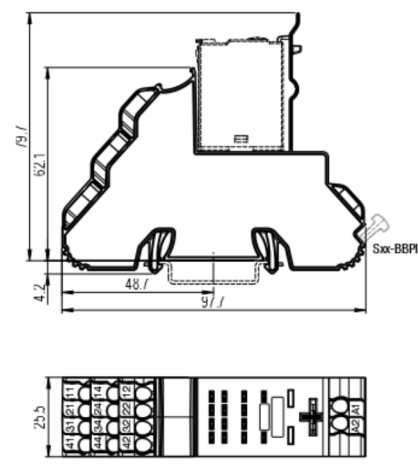

fig. 2. Dimension (mm)



Technical approvals, conformities

Standards EN 60664-1;
 Railway standards EN 50155; EN 45545-2
 Approvals

S10-P

PCB Socket for 5-pin Relays

Rated Load	10 A / 250 V
Specifications	
Rated impulse withstand voltage	5 kV rms / 1 min
- Pin / Pin	-40 ... 60 °C / -40 ... 80 °C (no ice)
Ambient temperature operation/storage	
Weight	7g
Included Accessories	
Retaining clip, plastic	



Printed circuit lay-out (mm)

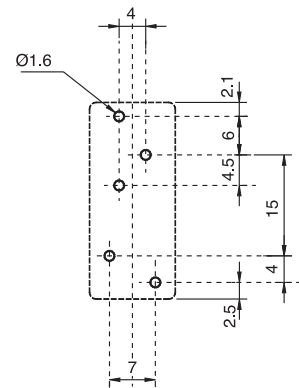

Dimensions (mm)

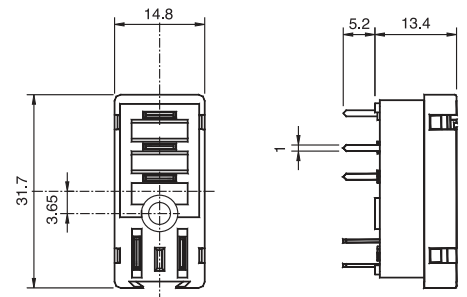

Technical approvals, conformities



S12-P

PCB Socket for 8-pin Relays

Rated Load **5 A / 250 V**

Specifications

Rated impulse withstand voltage	
- Pin / Pole	3 kV rms / 1 min
- Coil / contact terminals	5 kV rms / 1 min
Weight	7g

Included Accessories

Retaining clip, plastic CP-24B (BAG 10 PCS) for C12 / C12x Relays



Printed circuit lay-out (mm)

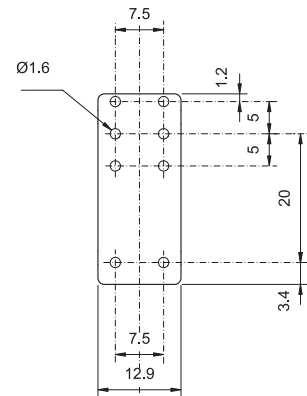

Dimensions (mm)

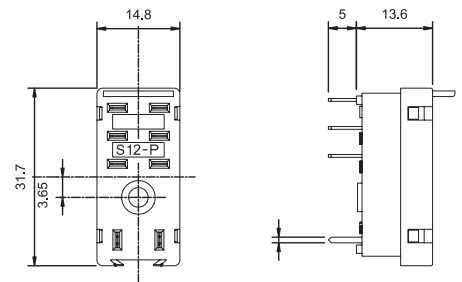

Technical approvals, conformities



S10-PI

5-pin C10 Relay socket | Push-In



General data

Rated load	10 A / 250 V
Dielectric strength	
- All terminals / DIN rail	2.5 kV rms / 1 min
- Terminal / terminal	2.5 kV rms / 1 min
- Contact / coil terminal	2.5 kV rms / 1 min
Cross-section of connecting wire	
- Single wire	2 x 0.34 mm ² / AWG 22 ... 2 x 2.5 mm ² / AWG 14 Use copper conductors only Max. jacket diameter 4.0 mm Stripping length 8 mm
- Multi wire (un-crimped)	2 x 0.34 mm ² / AWG 22 ... 2 x 2.5 mm ² / AWG 14 Use copper conductors only Max. jacket diameter 4.0 mm Stripping length 8 mm
- Multi wire (crimped)	2 x 0.34 mm ² / AWG 22 ... 2 x 1.5 mm ² / AWG 16 Use copper conductors only Max. jacket diameter 4.0 mm Stripping length 8 mm
Mounting	TH35 (EN 60715)
Ambient temperature storage (no ice)	-40 ... 80 °C
Ambient temperature operation	-40 ... 60 °C
Weight	33 g
Housing material	PA

Included Accessories

Retaining clip, steel	S10-CPI
-----------------------	---------

Optional Accessories

Retaining clip, steel	S10-CPI (BAG 10 PCS)
Bridge A2 for Sx-PI / Sx-PIR	Sxx-BBPI (BAG 20 PCS)
2-way bridge for main circuit terminals	Sxx-BBPI2 (BAG 20 PCS)
4-way bridge for main circuit terminals	Sxx-BBPI4 (BAG 20 PCS)
Multi-operation tool kit for Push-in sockets	OT-PI kit
Marking strip	BS11-PI (50m tape)

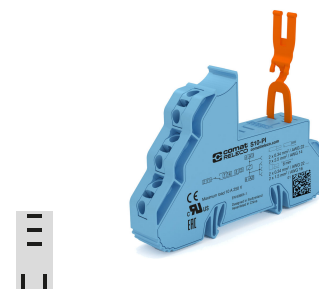

fig. 1. Wiring diagram

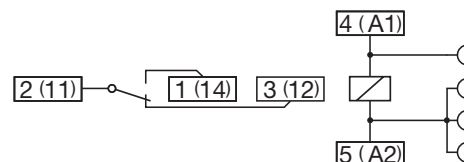
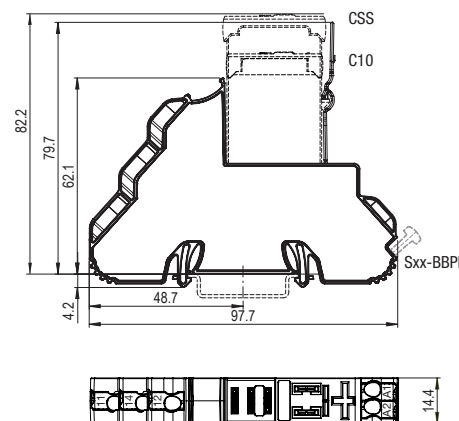

fig. 2. Dimension (mm)



Technical approvals, conformities

Standards EN 60664-1

Approvals

S10-PIR

5-pin socket for R10 relay | Push-In



General data

Rated load	10 A / 250 V
Dielectric strength	
- All terminals / DIN rail	2.5 kV rms / 1 min
- Terminal / terminal	2.5 kV rms / 1 min
- Contact / coil terminal	2.5 kV rms / 1 min
Cross-section of connecting wire	
- Single wire	2 x 0.34 mm ² / AWG 22 ... 2 x 2.5 mm ² / AWG 14 Use copper conductors only Max. jacket diameter 4.0 mm Stripping length 8 mm
- Multi wire (un-crimped)	2 x 0.34 mm ² / AWG 22 ... 2 x 2.5 mm ² / AWG 14 Use copper conductors only Max. jacket diameter 4.0 mm Stripping length 8 mm
- Multi wire (crimped)	2 x 0.34 mm ² / AWG 22 ... 2 x 1.5 mm ² / AWG 16 Use copper conductors only Max. jacket diameter 4.0 mm Stripping length 8 mm
Mounting	TH35 (EN 60715)
Ambient temperature storage (no ice)	-40 ... 80 °C
Ambient temperature operation	-40 ... 70 °C
Weight	33 g
Housing material	PA

Included Accessories

Retaining clip, steel	S10-CPI
-----------------------	---------

Optional Accessories

Retaining clip, steel	S10-CPI (BAG 10 PCS)
Bridge A2 for Sx-PI / Sx-PIR	Sxx-BBPI (BAG 20 PCS)
2-way bridge for main circuit terminals	Sxx-BBPI2 (BAG 20 PCS)
4-way bridge for main circuit terminals	Sxx-BBPI4 (BAG 20 PCS)
Multi-operation tool kit for Push-in sockets	OT-PI kit
Marking strip	BS11-PI (50m tape)

Applicable tools

Operation tool	ISO 2380-1 Shape A, width: 2.5 mm
----------------	-----------------------------------

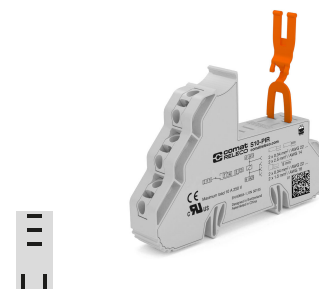

fig. 1. Wiring diagram

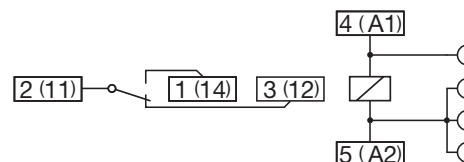
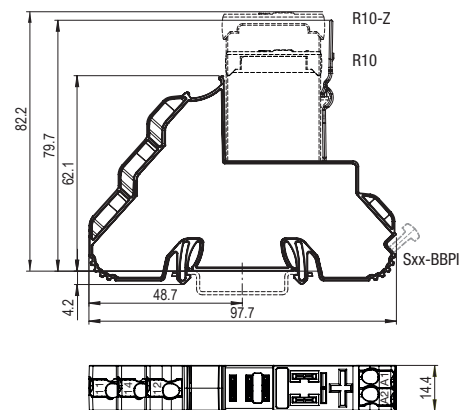

fig. 2. Dimension (mm)



Technical approvals, conformities

Standards	EN 60664-1
Railway	EN 45545-2; EN 50155
Approvals	CE C RU US

S12-PI

8-pin C12 Relay socket | Push-In



General data

Rated load	5 A / 250 V
Dielectric strength	
- All terminals / DIN rail	2.5 kV rms / 1 min
- Terminal / terminal	2.5 kV rms / 1 min
- Contact / coil terminal	2.5 kV rms / 1 min
Cross-section of connecting wire	
- Single wire	2 x 0.34 mm ² / AWG 22 ... 2 x 2.5 mm ² / AWG 14 Use copper conductors only Max. jacket diameter 4.0 mm Stripping length 8 mm
- Multi wire (un-crimped)	2 x 0.34 mm ² / AWG 22 ... 2 x 2.5 mm ² / AWG 14 Use copper conductors only Max. jacket diameter 4.0 mm Stripping length 8 mm
- Multi wire (crimped)	2 x 0.34 mm ² / AWG 22 ... 2 x 1.5 mm ² / AWG 16 Use copper conductors only Max. jacket diameter 4.0 mm Stripping length 8 mm
Mounting	TH35 (EN 60715)
Ambient temperature storage (no ice)	-40 ... 80 °C
Ambient temperature operation	-40 ... 60 °C
Weight	39 g
Housing material	PA

Included Accessories

Retaining clip, steel	S10-CPI
-----------------------	---------

Optional Accessories

Retaining clip, steel	S10-CPI (BAG 10 PCS)
Bridge A2 for Sx-PI / Sx-PIR	Sxx-BBPI (BAG 20 PCS)
2-way bridge for main circuit terminals	Sxx-BBPI2 (BAG 20 PCS)
4-way bridge for main circuit terminals	Sxx-BBPI4 (BAG 20 PCS)
Multi-operation tool kit for Push-in sockets	OT-PI kit
Marking strip	BS11-PI (50m tape)

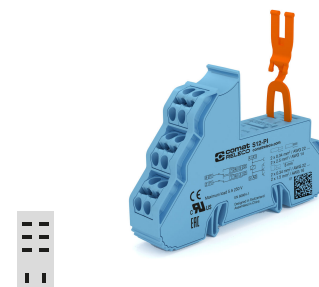

fig. 1. Wiring diagram

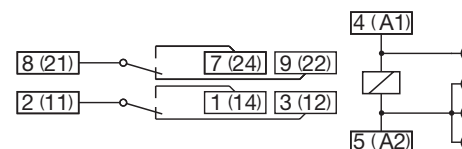
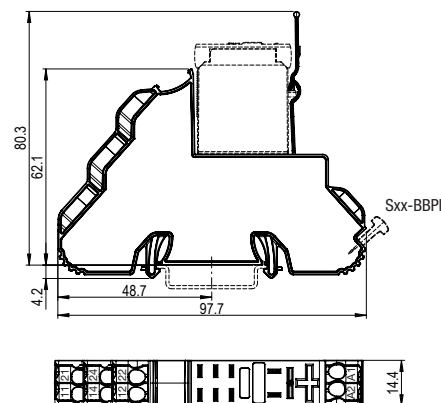

fig. 2. Dimension (mm)



Technical approvals, conformities

Standards EN 60664-1

Approvals

S12-PIR

8-pin socket for R12 relay | Push-In



General data

Rated load	5 A / 250 V
Dielectric strength	
- All terminals / DIN rail	2.5 kV rms / 1 min
- Terminal / terminal	2.5 kV rms / 1 min
- Contact / coil terminal	2.5 kV rms / 1 min
Cross-section of connecting wire	
- Single wire	2 x 0.34 mm ² / AWG 22 ... 2 x 2.5 mm ² / AWG 14 Use copper conductors only Max. jacket diameter 4.0 mm Stripping length 8 mm
- Multi wire (un-crimped)	2 x 0.34 mm ² / AWG 22 ... 2 x 2.5 mm ² / AWG 14 Use copper conductors only Max. jacket diameter 4.0 mm Stripping length 8 mm
- Multi wire (crimped)	2 x 0.34 mm ² / AWG 22 ... 2 x 1.5 mm ² / AWG 16 Use copper conductors only Max. jacket diameter 4.0 mm Stripping length 8 mm
Mounting	TH35 (EN 60715)
Ambient temperature storage (no ice)	-40 ... 80 °C
Ambient temperature operation	-40 ... 70 °C
Weight	39 g
Housing material	PA

Optional Accessories

Retaining clip, plastic	S10-CPI (BAG 10 PCS)
Bridge A2 for Sx-PI / Sx-PIR	Sxx-BBPI (BAG 20 PCS)
2-pole bridge bar	Sxx-BBPI2 (BAG 20 PCS)
4-pole bridge bar for main circuit terminals	Sxx-BBPI4 (BAG 20 PCS)
Multi-operation tool kit for Push-in sockets	OT-PI kit
Marking strip	BS11-PI (50m tape)

Applicable tools

Operation tool	ISO 2380-1 Shape A, width: 2.5 mm
----------------	-----------------------------------

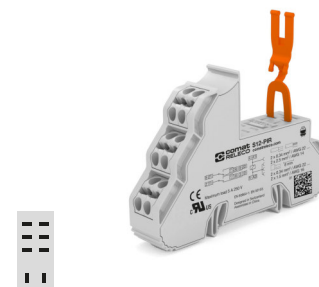

fig. 1. Wiring diagram

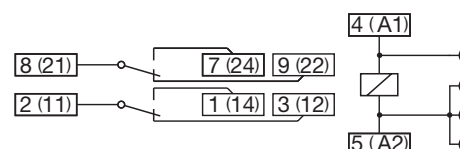
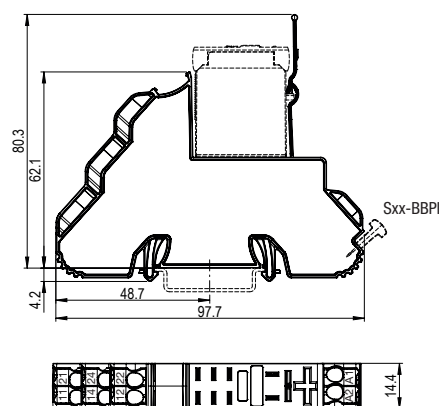

fig. 2. Dimension (mm)



Technical approvals, conformities

Standards EN 60664-1
Railway EN 45545-2; EN 50155

Approvals